

SEAWORLD REALM ICONS

SAN DIEGO, CA

SEAWORLD
SAN DIEGO
REALM ICONS

DRAWING INDEX		
Sheet	Sheet Title	REV
000.00	COVER AND INDEX	--
001.01	GENERAL INFORMATION	--
010.01	TYPICAL SLAB AND FOOTER DETAIL	1
010.02	TYPICAL SLAB AND FOOTER DETAIL	1
020.01	TYPICAL DOLPHIN SWELLS DETAILS	--
020.02	TYPICAL ORCA SWELLS DETAILS	--
021.01	TYPICAL SWIMMING DOLPHIN DETAILS	--
021.02	TYPICAL SWIMMING ORCA DETAILS	--
022.01	TYPICAL SWELL DOLPHIN AND ORCA MOUNT DETAILS	1
030.01	FIBERGLASS TO FRAME ATTACHMENT DETAIL	--
100.01	SITE PLAN	1
200.01	ORCA ENTRY POINT ICON EP-A LOCATION PLAN (PLANTER 3)	1
300.01	ORCA MAIN PLANTER ICON EP-B LOCATION PLAN (PLANTER 2)	1
301.01	BREACHING ORCA ISOs PLAN AND ELEVATIONS	--
302.01	BREACHING ORCA SECTION	--
310.01	BREACHING ORCA FRAME	--
310.02	BREACHING ORCA FRAME	--
400.01	DOLPHIN CENTRAL PLANTER ICON DP-A LOCATION PLAN (PLANTER 1)	1
401.01	BREACHING DOLPHIN ISOs PLAN AND ELEVATIONS	--
402.01	BREACHING DOLPHINS SECTIONS	--
410.01	BREACHING DOLPHINS FRAME	--
410.02	BREACHING DOLPHINS FRAME	--
500.01	OCEANS PLAYGROUND DOLPHIN ICON OP-A LOCATION PLAN (PLANTER 4)	1
600.01	DOLPHIN PLANTER ICON OP-B LOCATION PLAN (PLANTER 5)	1
601.01	PARTIAL BREACHING DOLPHIN ISOs PLAN AND ELEVATIONS	--
602.01	PARTIAL BREACHING DOLPHIN SECTION	--
610.01	PARTIAL BREACHING DOLPHIN FRAME	--
700.01	REEF EXPLORER ENTRY PORTAL RF-A LOCATION PLAN (PLANTER 6)	--
701.01	REEF EXPLORER ENTRY PORTAL RF-A	--
701.02	REEF EXPLORER ENTRY PORTAL RF-A	--
701.03	REEF EXPLORER ENTRY PORTAL RF-A	--
701.04	REEF EXPLORER ENTRY PORTAL RF-A	--
701.05	REEF EXPLORER ENTRY PORTAL RF-A	--
702.01	REEF EXPLORER ENTRY PORTAL RF-A	--
702.02	REEF EXPLORER ENTRY PORTAL RF-A	--
703.01	REEF EXPLORER ENTRY PORTAL RF-A	--
704.01	REEF EXPLORER ENTRY PORTAL RF-A	--
710.01	REEF EXPLORER ENTRY PORTAL RF-A	--
710.02	REEF EXPLORER ENTRY PORTAL RF-A	--

REV.	DATE	BY	DESCRIPTION
△			
△			
△			
△			
△			
△			

This Document contains confidential material and trade secret information belonging exclusively to the client. Any unauthorized use, disclosure, dissemination or duplication of the information contained herein may result in liability under applicable laws.



Drawn By:
JSL

Checked By: MN Date: 07-07-22

Job Number:
1059

Project:
SWSD REALM ICONS

Building/Attraction:

Drawing Title:
COVER AND INDEX

Part No.

Scale:
AS NOTED

Drawing No. 000.00	REV. ----
-----------------------	--------------

THESE DRAWINGS MAY NOT BE USED FOR ANY PURPOSE WITHOUT PRIOR WRITTEN CONSENT OF THE NASSAL CO.

SEAWORLD SAN DIEGO REALM ICONS

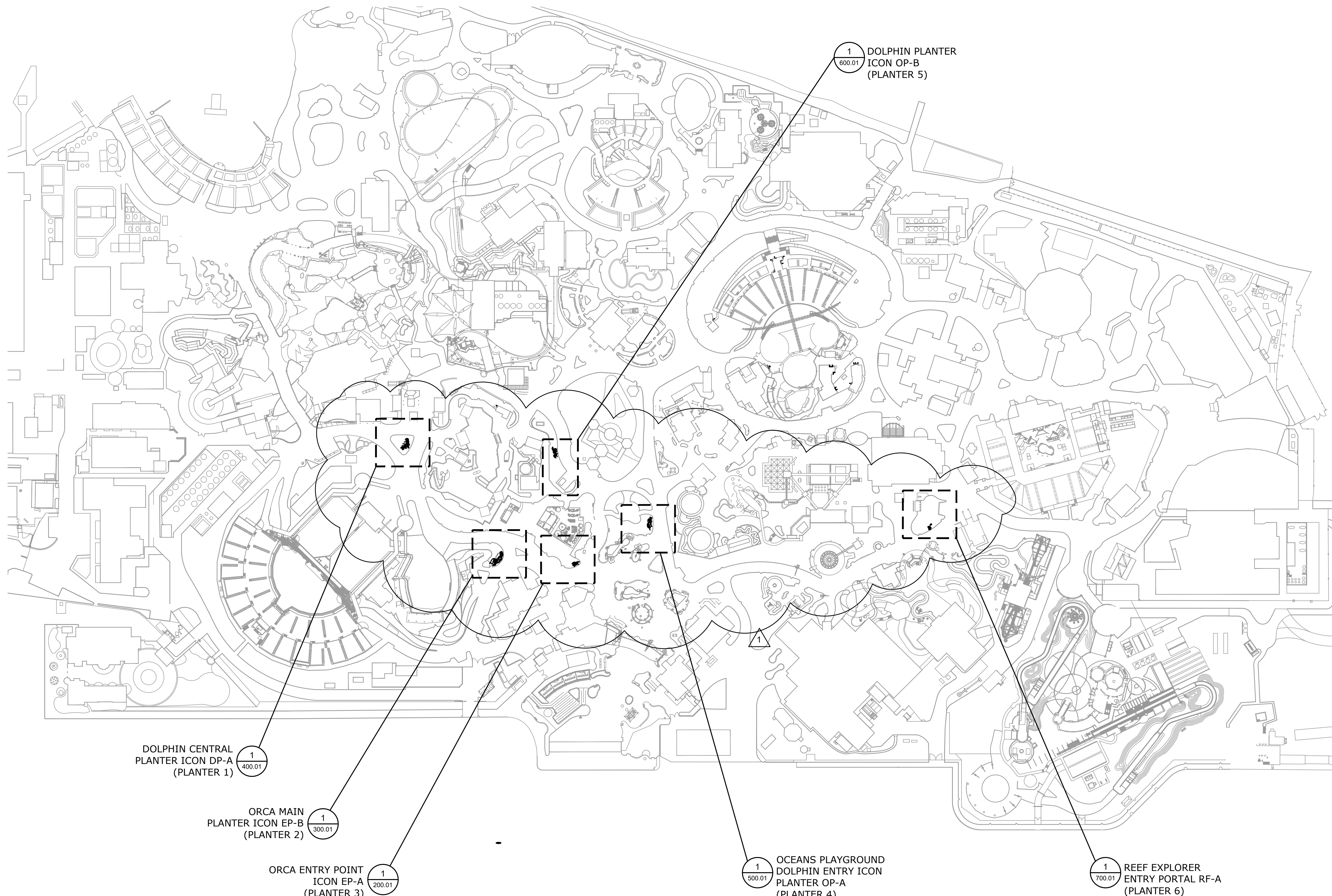

1 SITE PLAN
SCALE: NONE



REV.	DATE	BY	DESCRIPTION
△			
△			
△			
△			
△			
△			
1	12-03-22	JSL	REVISION

This Document contains confidential material and trade secret information belonging exclusively to the client. Any unauthorized use, disclosure, dissemination or duplication of the information contained herein may result in liability under applicable laws.



Drawn By: JSL	
Checked By: MN	Date: 07-07-22
Job Number: 1059	
Project: SWSD REALM ICONS	
Building/Attraction:	
Drawing Title: SITE PLAN	
Part No.:	
Scale: AS NOTED	
Drawing No. 100.01	REV. ----

THESE DRAWINGS MAY NOT BE USED FOR ANY PURPOSE WITHOUT PRIOR WRITTEN CONSENT OF THE NASSAL CO.

SEAWORLD SAN DIEGO REALM ICONS

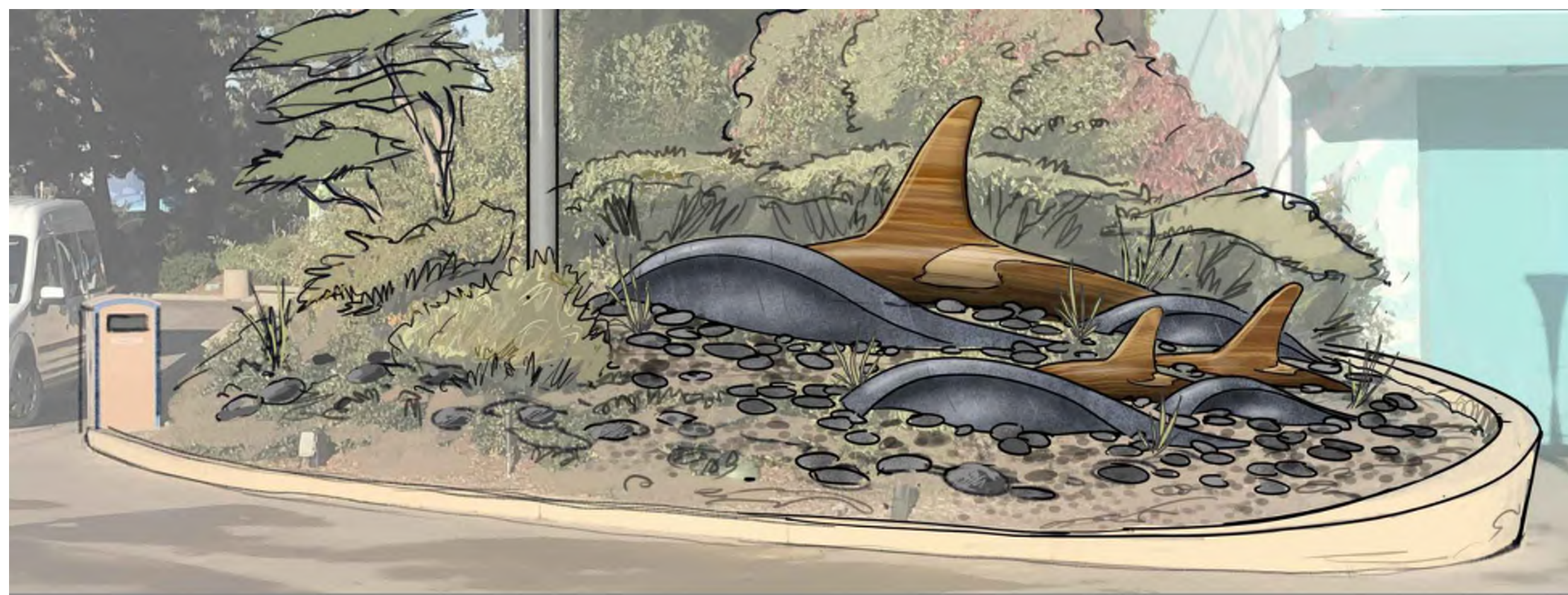

ORCA ENTRY POINT ICON EP-A REF IMAGE

NOTE:
SEE SHEET 020.02 FOR
TYPICAL ORCA SWELLS
021.02 FOR SWIMMING
ORCAS

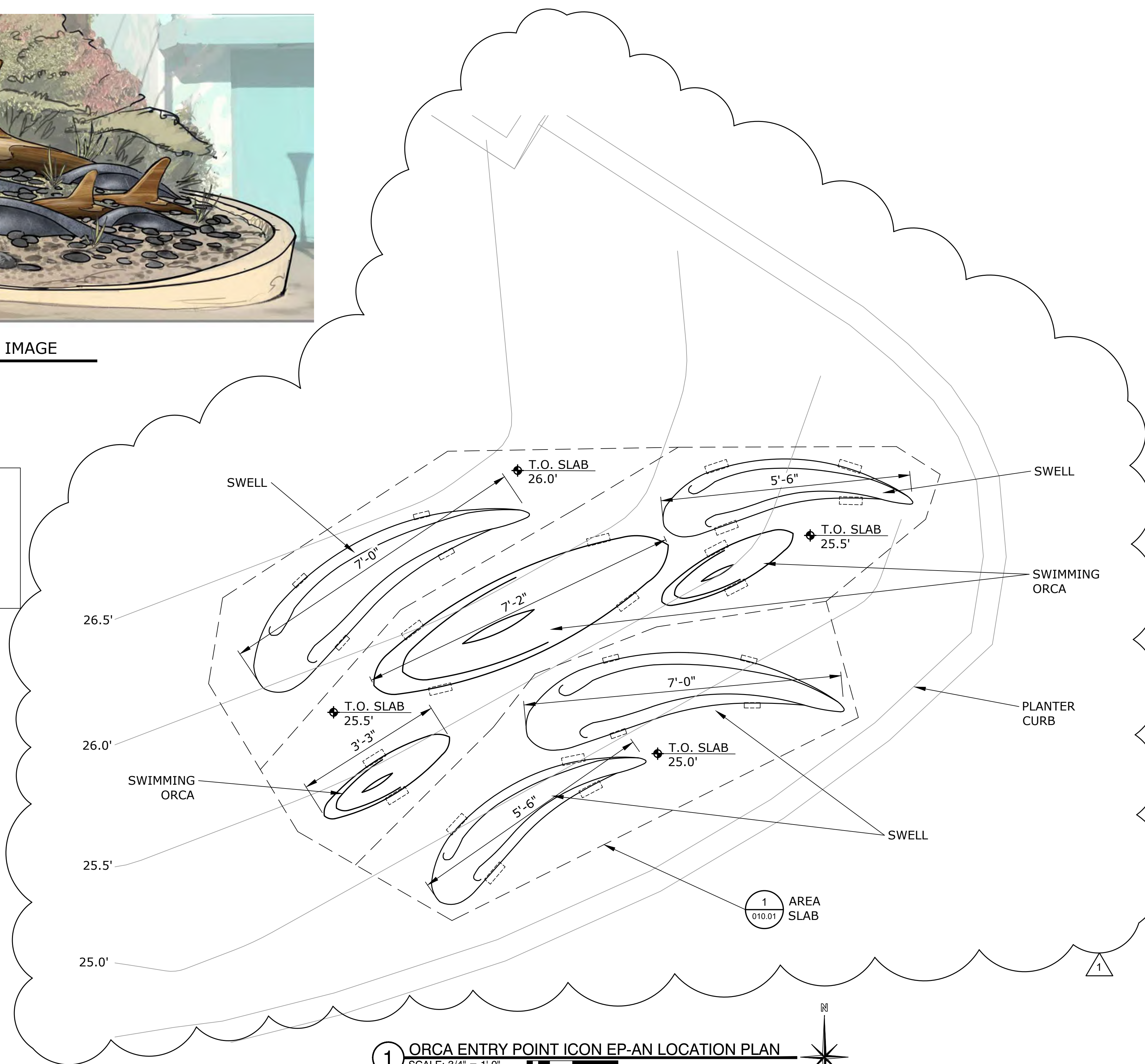

1 ORCA ENTRY POINT ICON EP-A LOCATION PLAN
SCALE: 3/4" = 1'-0"

REV.	DATE	BY	DESCRIPTION
△			
△			
△			
△			
△			
△			
1	12-03-22	JSL	REVISION

This Document contains confidential material and trade secret information belonging exclusively to the client. Any unauthorized use, disclosure, dissemination or duplication of the information contained herein may result in liability under applicable laws.



Drawn By: JSL	Date: 07-07-22
Checked By: MN	Job Number: 1059
Project: SWSD REALM ICONS	
Building/Attraction: PLANTER 3	
Drawing Title: ORCA ENTRY POINT ICON EP-A LOCATION PLAN (PLANTER 3)	
Part No.:	
Scale: AS NOTED	
Drawing No. 200.01	REV. ----

THESE DRAWINGS MAY NOT BE USED FOR ANY PURPOSE WITHOUT PRIOR WRITTEN CONSENT OF THE NASSAL CO.

SEAWORLD SAN DIEGO REALM ICONS



ORCA MAIN PLANTER ICON EP-B REF IMAGE

NOTE:
SEE SHEET 020.02 FOR
TYPICAL ORCA SWELLS

021.02 FOR SWIMMING
ORCAS

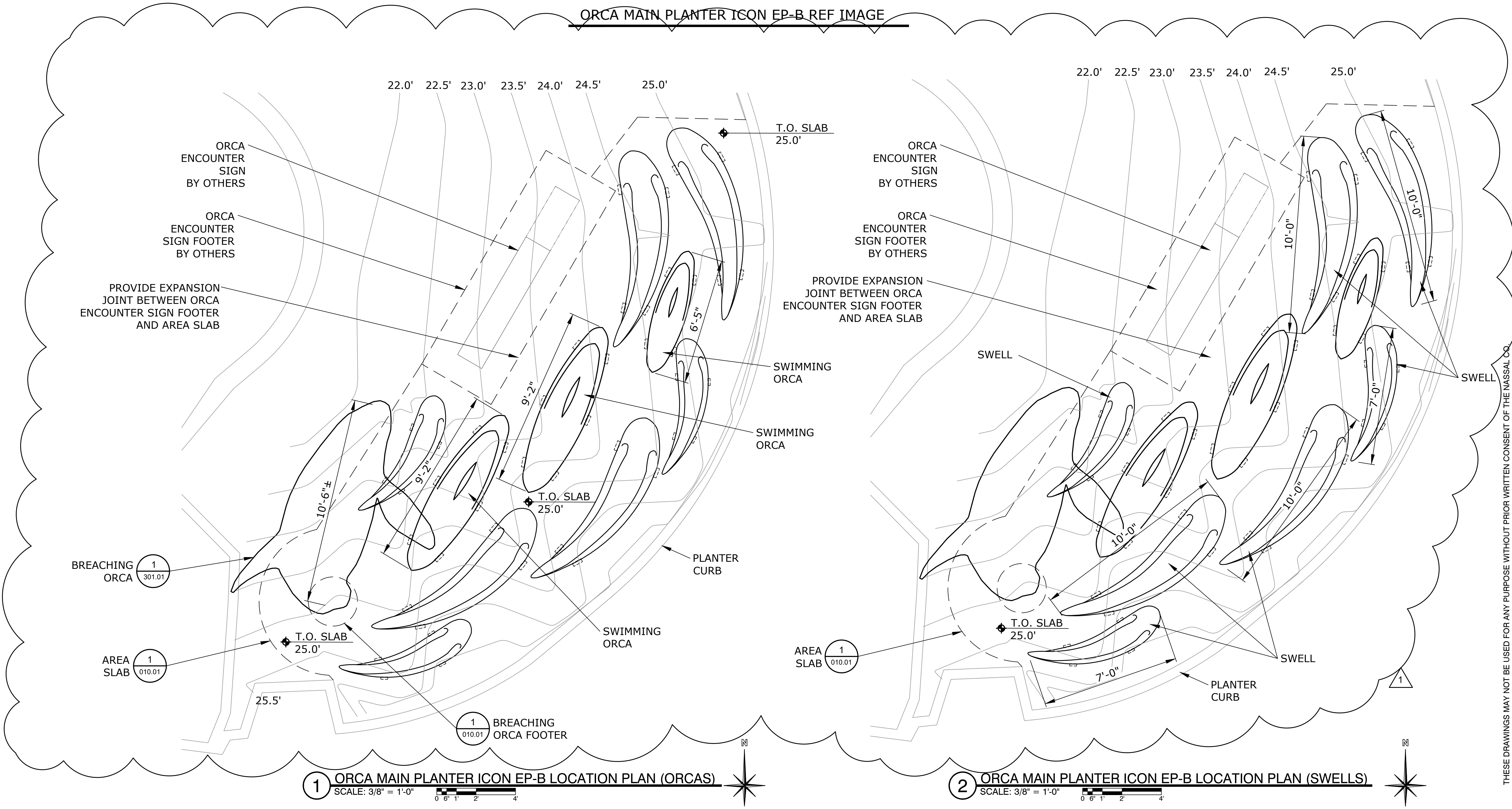

1 ORCA MAIN PLANTER ICON EP-B LOCATION PLAN (ORCAS)
SCALE: 3/8" = 1'-0"

2 ORCA MAIN PLANTER ICON EP-B LOCATION PLAN (SWELLS)
SCALE: 3/8" = 1'-0"

REV.	DATE	BY	DESCRIPTION
△			
△			
△			
△			
△			
△			
1	12-03-22	JSL	REVISION

This Document contains confidential material and trade secret information belonging exclusively to the client. Any unauthorized use, disclosure, dissemination or duplication of the information contained herein may result in liability under applicable laws.



Drawn By: JSL	Date: 07-07-22
Checked By: MN	Date: 07-07-22
Job Number: 1059	
Project: SWSD REALM ICONS	
Building/Attraction: PLANTER 2	
Drawing Title: ORCA MAIN PLANTER ICON EP-B LOCATION PLAN (PLANTER 2)	
Part No.	
Scale: AS NOTED	
Drawing No. 300.01	REV. ----

THESE DRAWINGS MAY NOT BE USED FOR ANY PURPOSE WITHOUT PRIOR WRITTEN CONSENT OF THE NASSAL CO.



DOLPHIN CENTRAL PLANTER ICON DP-A REF IMAGE

NOTE:
SEE SHEET 020.01 FOR
TYPICAL DOLPHIN SWELLS

021.01 FOR SWIMMING
DOLPHINS

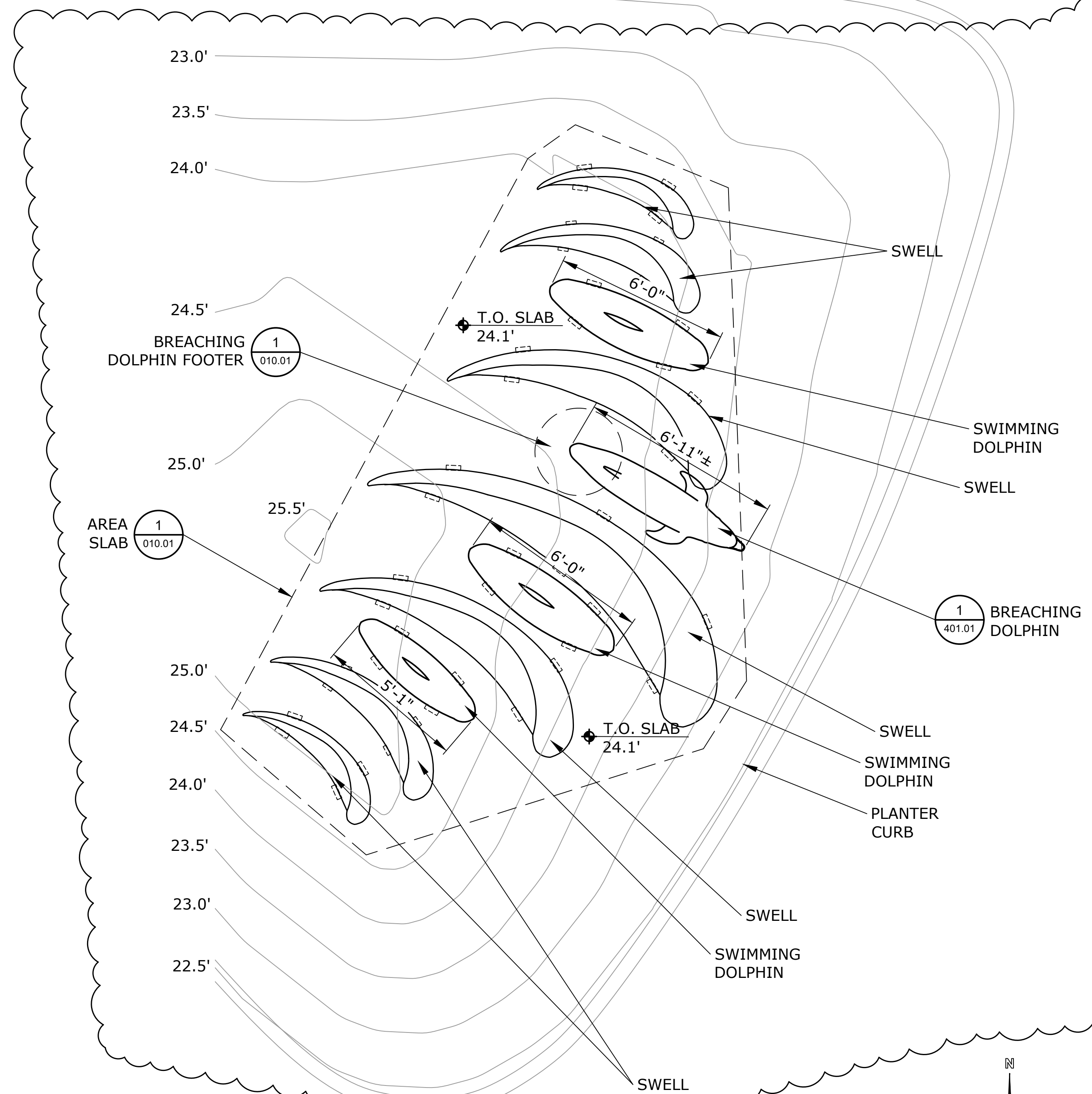

1 DOLPHIN CENTRAL PLANTER ICON DP-A LOCATION PLAN (DOLPHINS)
SCALE: 3/8" = 1'-0"

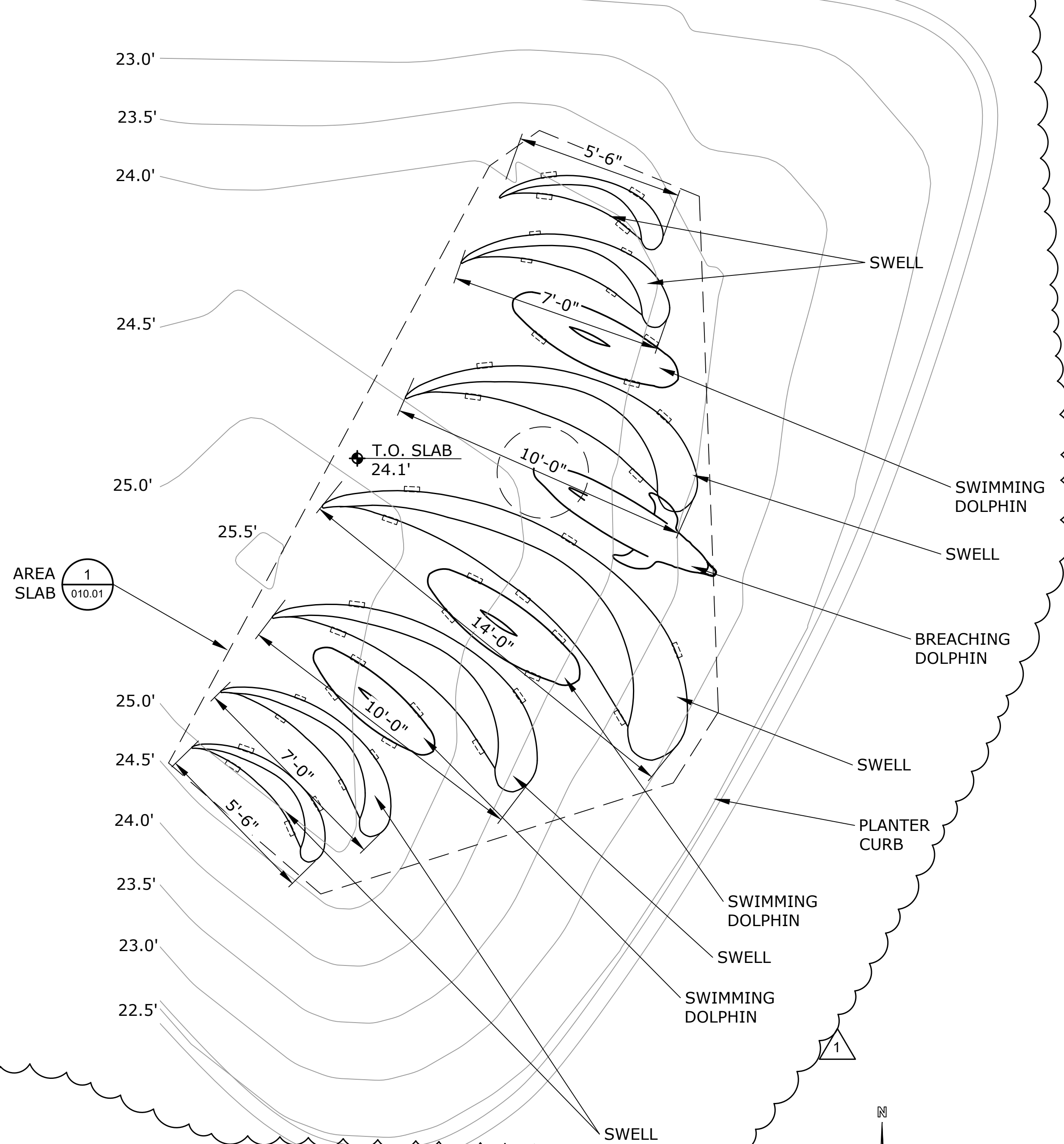

2 DOLPHIN CENTRAL PLANTER ICON DP-A LOCATION PLAN (SWELLS)
SCALE: 3/8" = 1'-0"

SEAWORLD SAN DIEGO REALM ICONS

REV.	DATE	BY	DESCRIPTION
△			
△			
△			
△			
△			
△			
1	12-03-22	JSL	REVISION

This Document contains confidential material and trade secret information belonging exclusively to the client. Any unauthorized use, disclosure, dissemination or duplication of the information contained herein may result in liability under applicable laws.



Drawn By: JSL	Date: 07-07-22
Checked By: MN	Date: 07-07-22
Job Number: 1059	
Project: SWSD REALM ICONS	
Building/Attraction: PLANTER 1	
Drawing Title: DOLPHIN CENTRAL PLANTER ICON DP-A LOCATION PLAN (PLANTER 1)	
Part No.	
Scale: AS NOTED	
Drawing No. 400.01	REV. ----

THESE DRAWINGS MAY NOT BE USED FOR ANY PURPOSE WITHOUT PRIOR WRITTEN CONSENT OF THE NASSAL CO.

SEAWORLD SAN DIEGO REALM ICONS



OCEANS PLAYGROUND DOLPHIN ENTRY ICON PLANTER OP-A REF IMAGE

NOTE:
SEE SHEET 020.01 FOR
TYPICAL DOLPHIN SWELLS

021.01 FOR SWIMMING
DOLPHINS

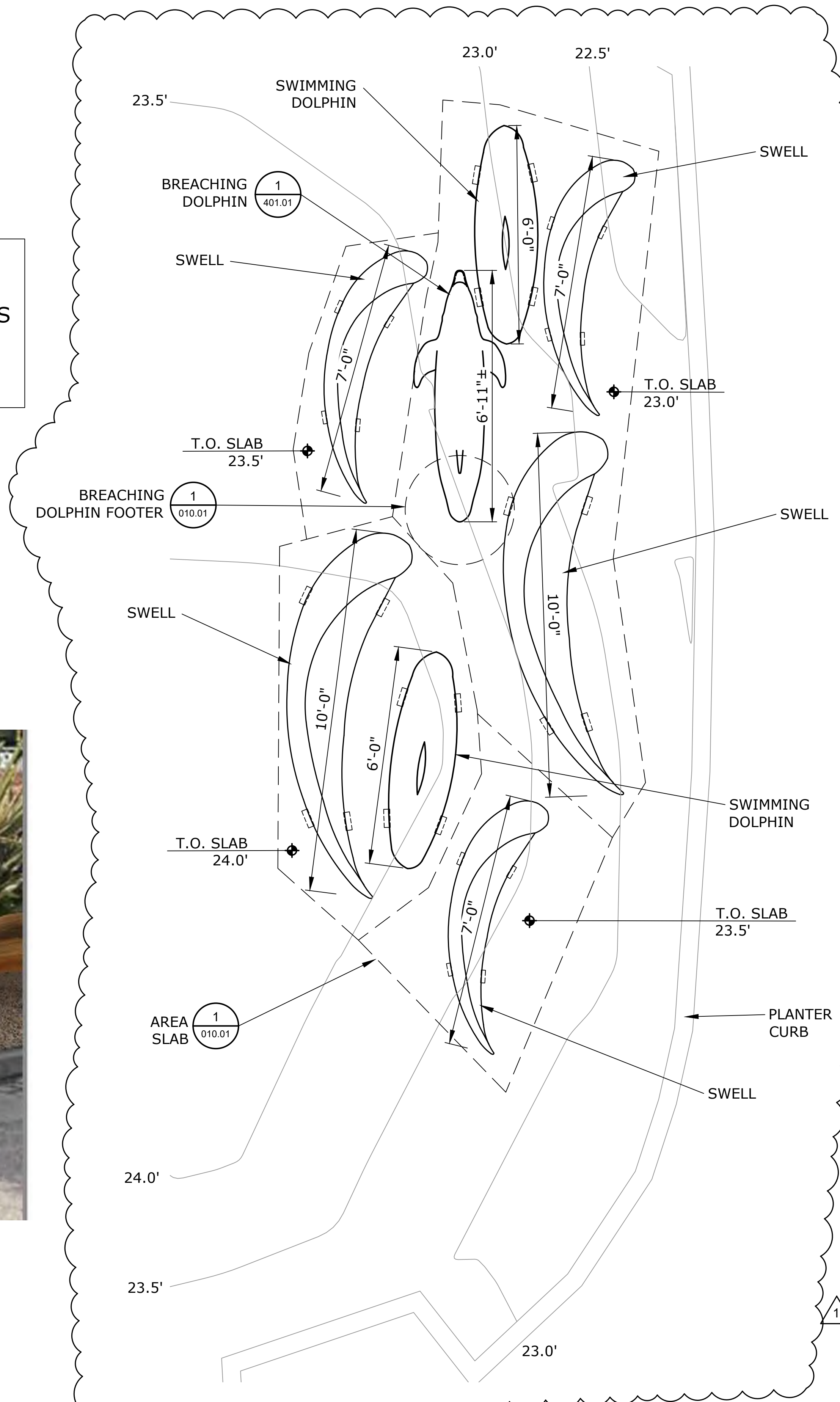

1 OCEANS PLAYGROUND DOLPHIN ENTRY ICON PLANTER OP-A LOCATION PLAN
SCALE: 1/2" = 1'-0"

REV.	DATE	BY	DESCRIPTION
△			
△			
△			
△			
△			
1	12-03-22	JSL	REVISION

This Document contains confidential material and trade secret information belonging exclusively to the client. Any unauthorized use, disclosure, dissemination or duplication of the information contained herein may result in liability under applicable laws.



Drawn By: JSL	
Checked By: MN	Date: 07-07-22
Job Number: 1059	
Project: SWSD REALM ICONS	
Building/Attraction: PLANTER 4	
Drawing Title: OCEANS PLAYGROUND DOLPHIN ICON OP-A LOCATION PLAN (PLANTER 4)	
Part No.	
Scale: AS NOTED	
Drawing No. 500.01	REV. ----

THESE DRAWINGS MAY NOT BE USED FOR ANY PURPOSE WITHOUT PRIOR WRITTEN CONSENT OF THE NASSAL CO.

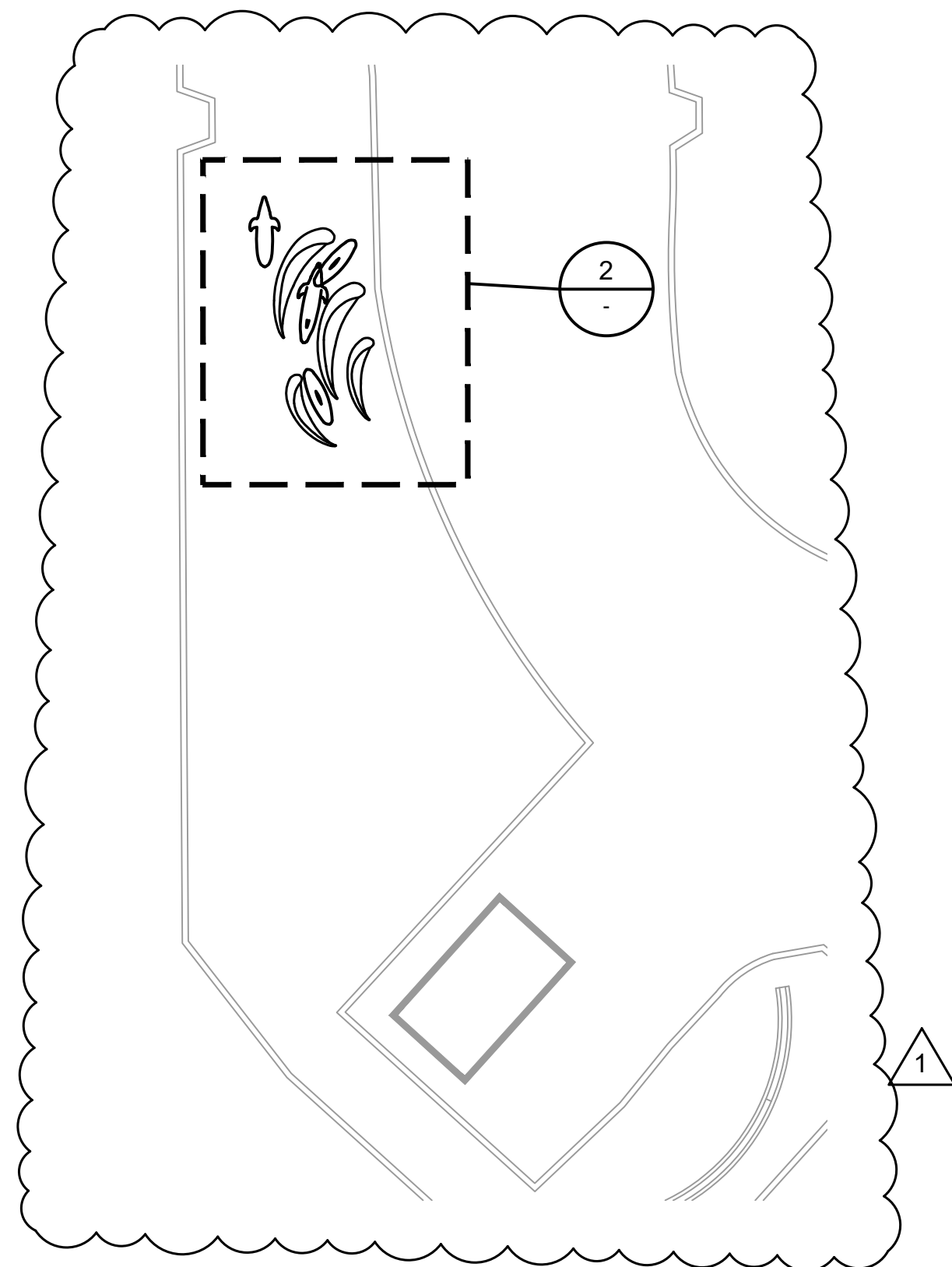

1 DOLPHIN PLANTER ICON OP-B LOCATION PLAN
 SCALE: 1/8" = 1'-0"
 0 1' 2' 4' 8'



DOLPHIN PLANTER ICON OP-B REF IMAGE

NOTE:
 SEE SHEET 020.01 FOR
 TYPICAL DOLPHIN SWELLS

021.01 FOR SWIMMING
 DOLPHINS

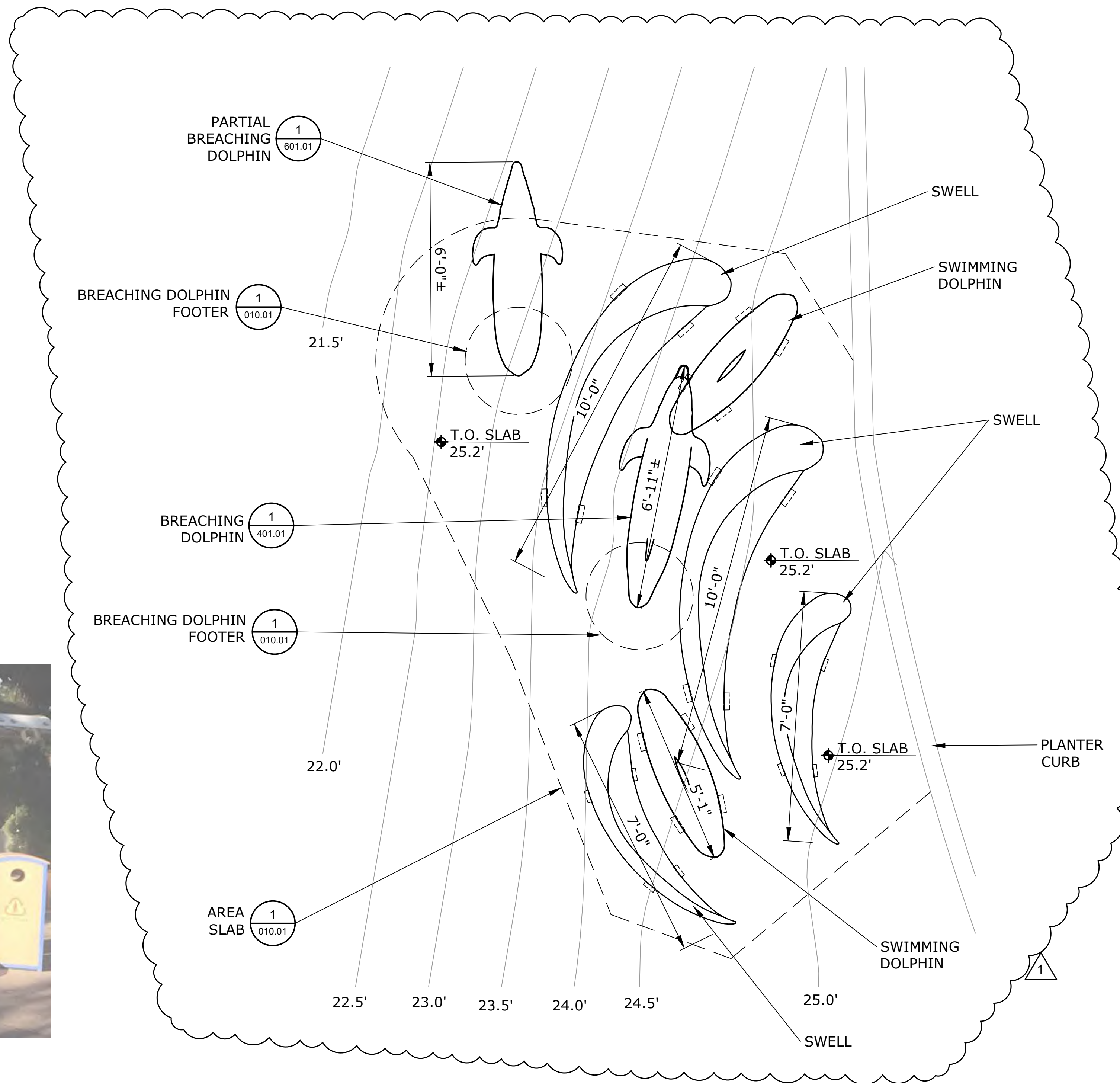

2 DOLPHIN PLANTER ICON OP-B ENLARGED PLAN
 SCALE: 1/2" = 1'-0"
 0 6' 1' 2'

**SEAWORLD
 SAN DIEGO
 REALM ICONS**

REV.	DATE	BY	DESCRIPTION
△			
△			
△			
△			
△			
1	12-03-22	JSL	REVISION

This Document contains confidential material and trade secret information belonging exclusively to the client. Any unauthorized use, disclosure, dissemination or duplication of the information contained herein may result in liability under applicable laws.



Drawn By: JSL	Date: 07-07-22
Checked By: MN	Job Number: 1059
Project: SWSD REALM ICONS	
Building/Attraction: PLANTER 5	
Drawing Title: DOLPHIN PLANTER ICON OP-B LOCATION PLAN (PLANTER 5)	
Part No.:	
Scale: AS NOTED	
Drawing No. 600.01	REV. ----

THESE DRAWINGS MAY NOT BE USED FOR ANY PURPOSE WITHOUT PRIOR WRITTEN CONSENT OF THE NASSAL CO.

SEAWORLD SAN DIEGO REALM ICONS

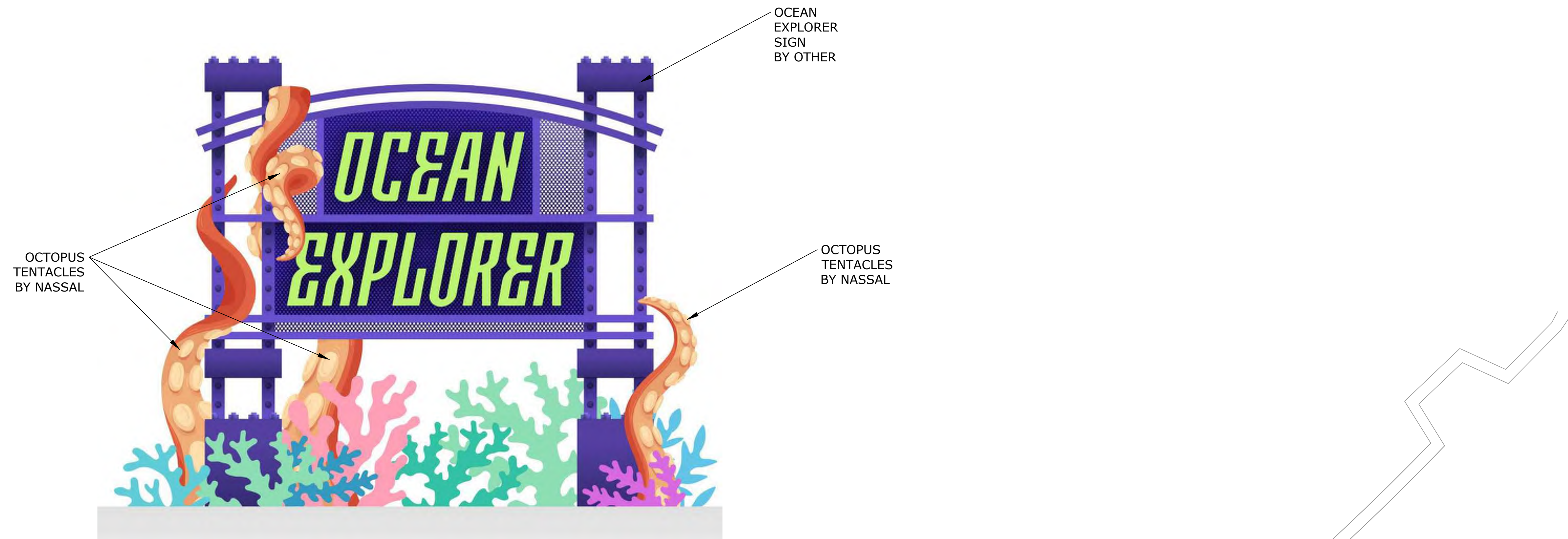

REEF EXPLORER ENTRY PORTAL RF-A REF IMAGE

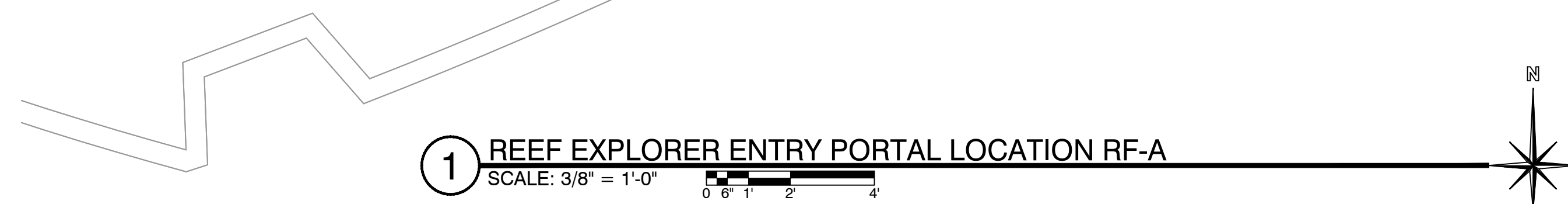
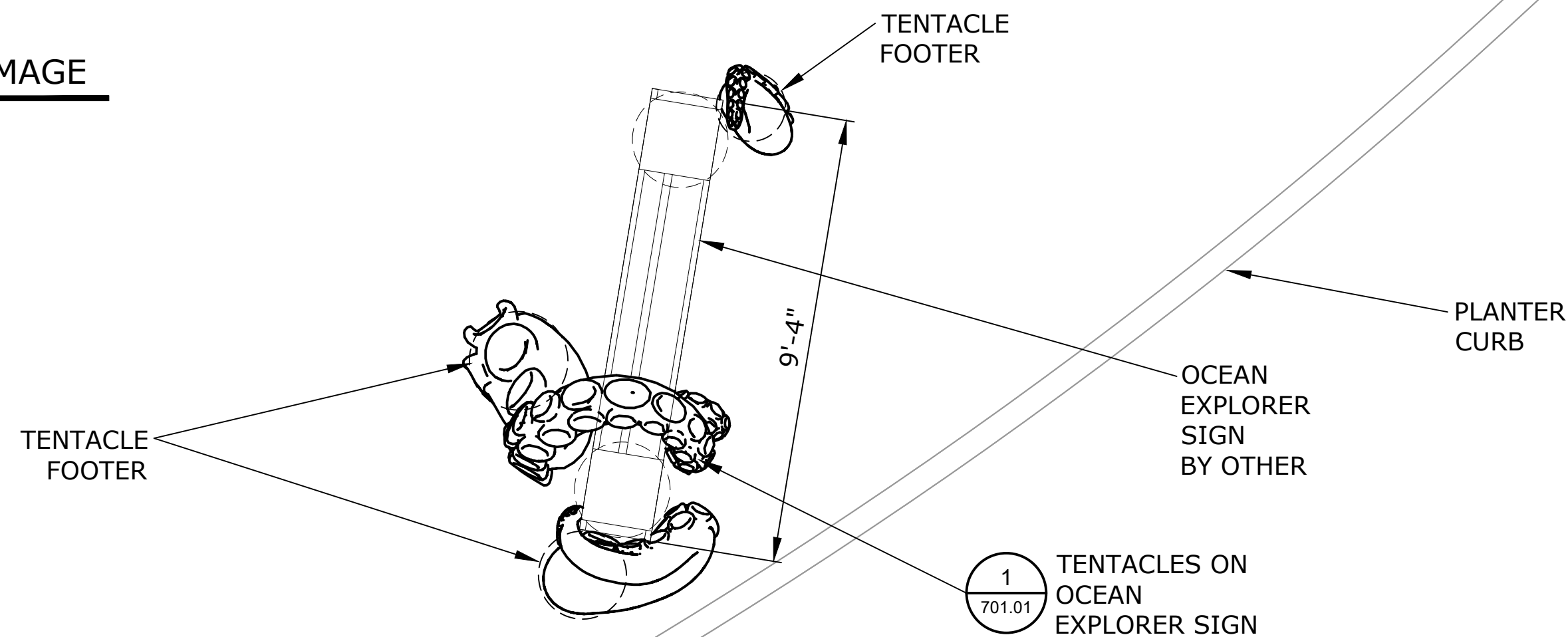

1 REEF EXPLORER ENTRY PORTAL LOCATION RF-A
SCALE: 3/8" = 1'-0"

REV.	DATE	BY	DESCRIPTION
△			
△			
△			
△			
△			
△			

This Document contains confidential material and trade secret information belonging exclusively to the client. Any unauthorized use, disclosure, dissemination or duplication of the information contained herein may result in liability under applicable laws.



Drawn By:
JSL

Checked By: MN Date: 07-07-22

Job Number:
1059

Project:
SWSD REALM ICONS

Building/Attraction:
PLANTER 6

Drawing Title:
REEF EXPLORER ENTRY PORTAL
RF-A LOCATION PLAN (PLANTER 6)

Part No.

Scale:
AS NOTED

Drawing No. 700.01	REV. ----
-----------------------	--------------

THESE DRAWINGS MAY NOT BE USED FOR ANY PURPOSE WITHOUT PRIOR WRITTEN CONSENT OF THE NASSAL CO.